

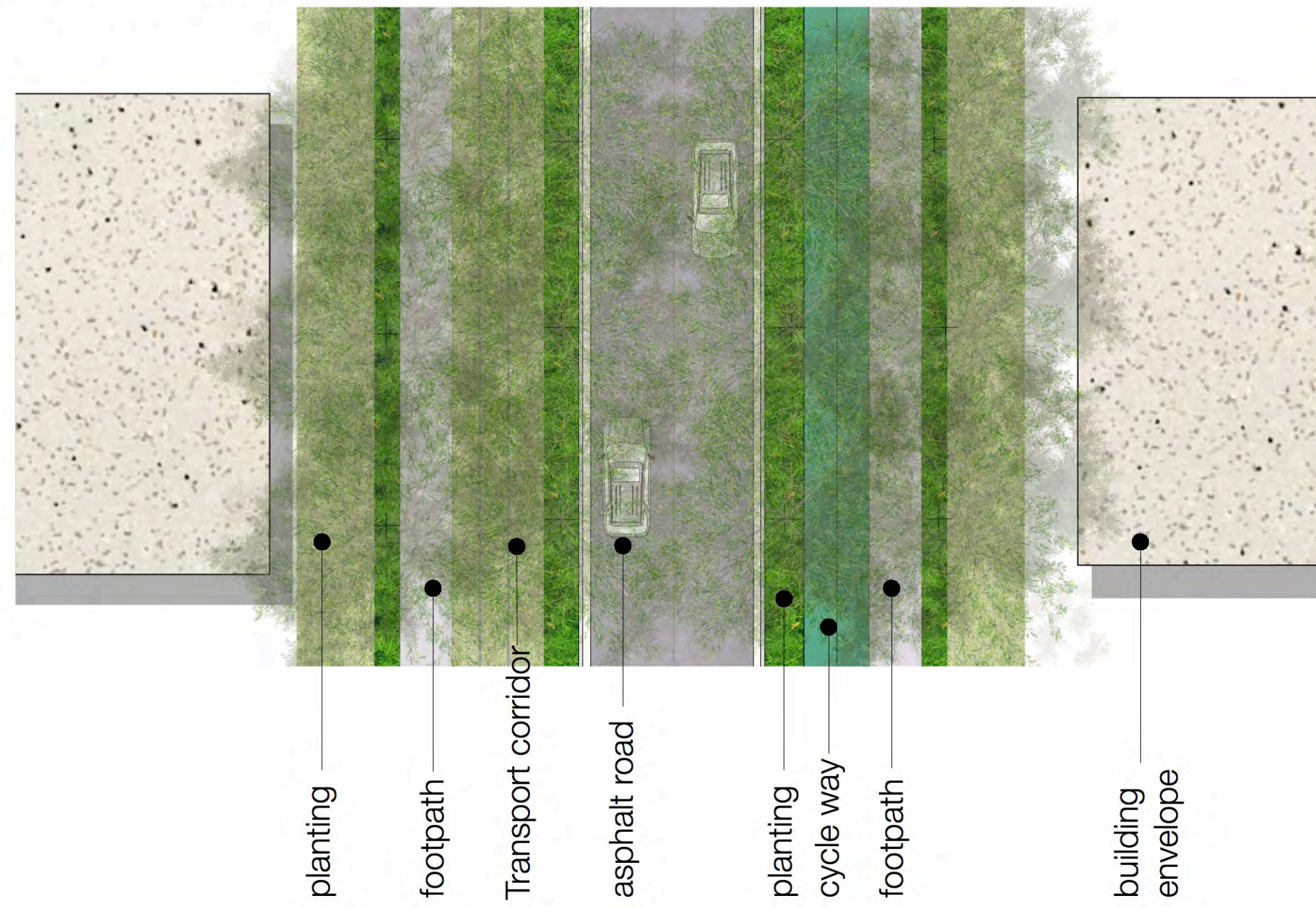

A-A Main Street



section  
plan



D-D Village Street

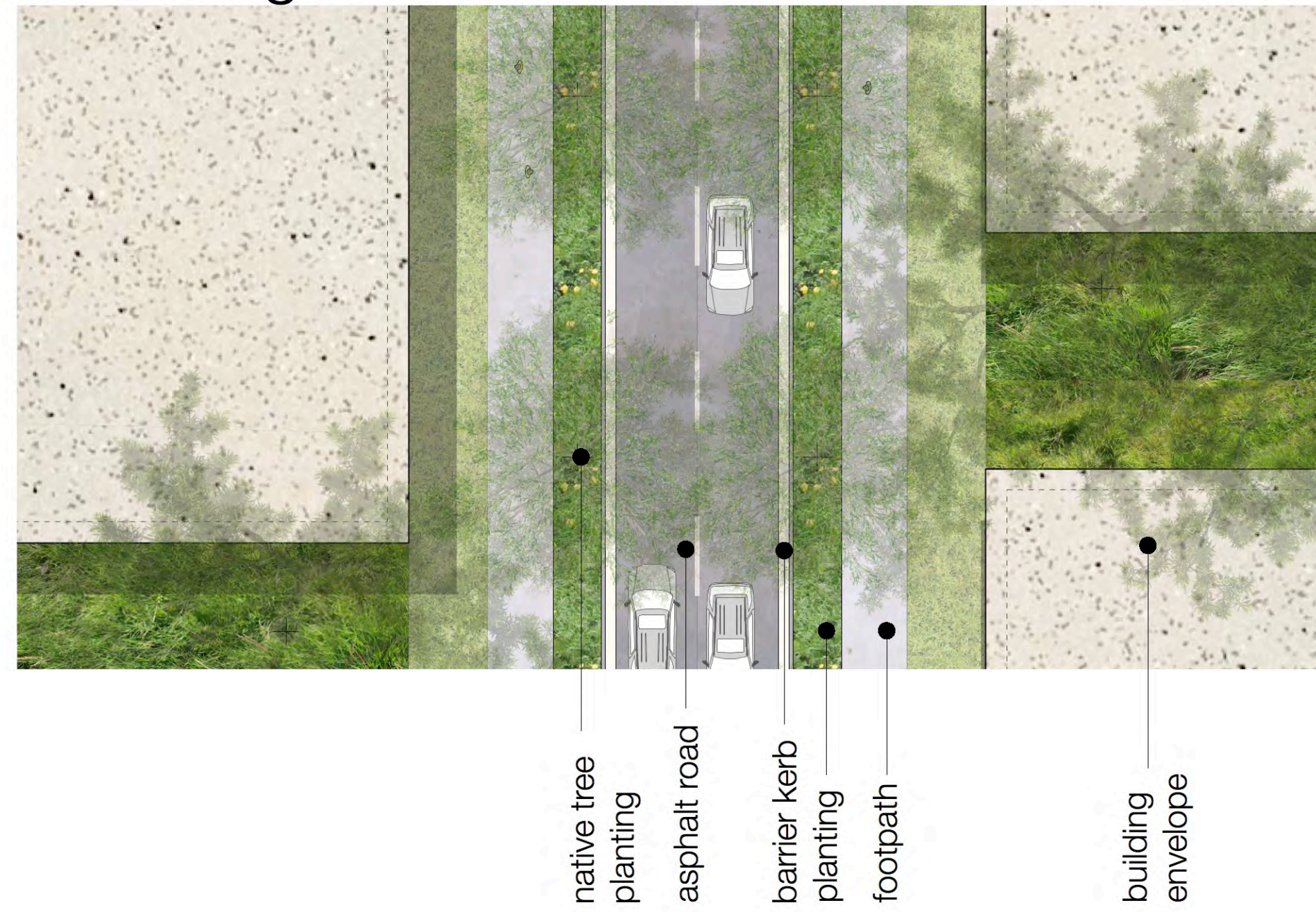

KEY PLAN

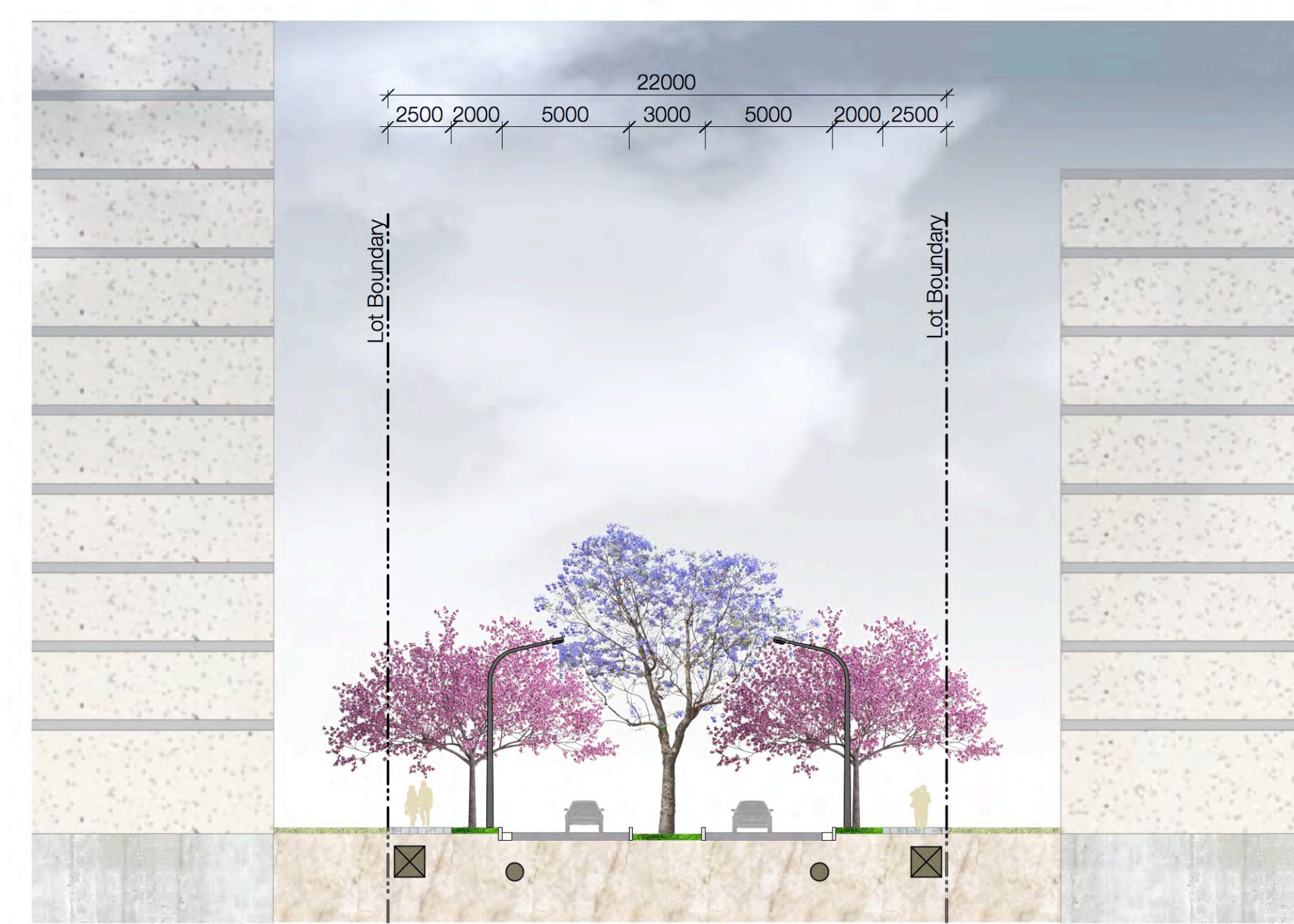

B-B Cherry Blossom Boulevard

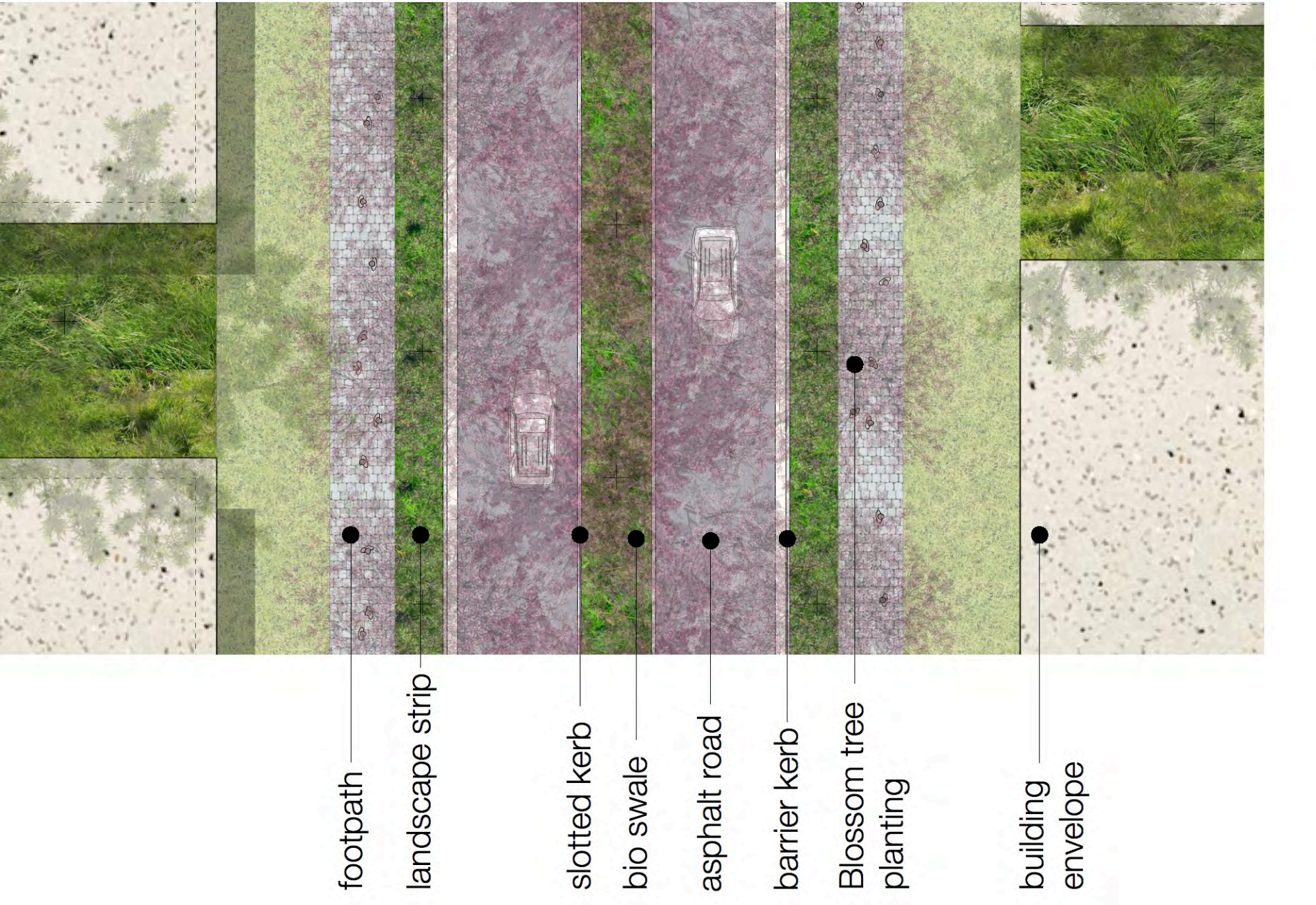

section  
plan

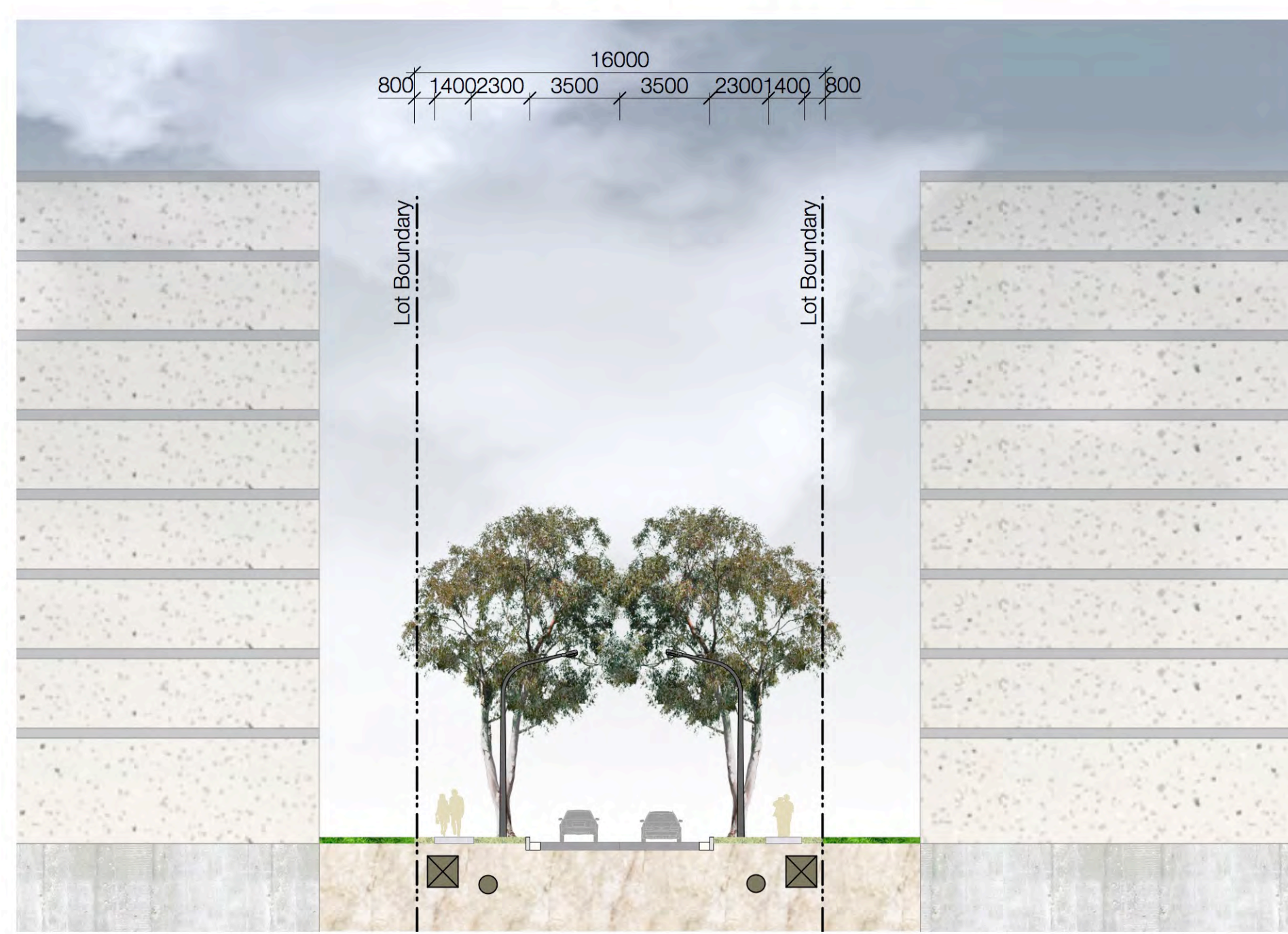

E-E Local Street

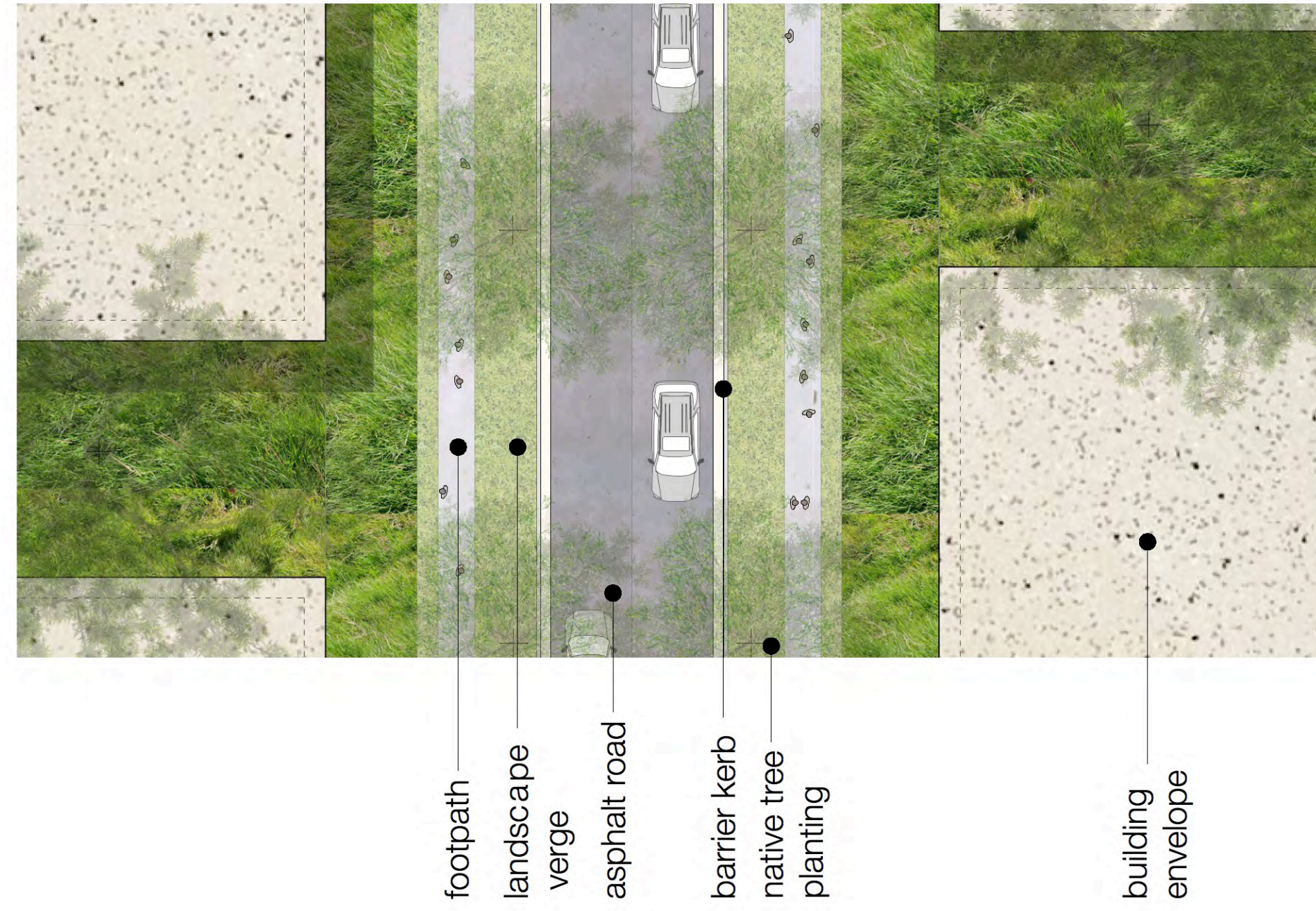

section  
plan

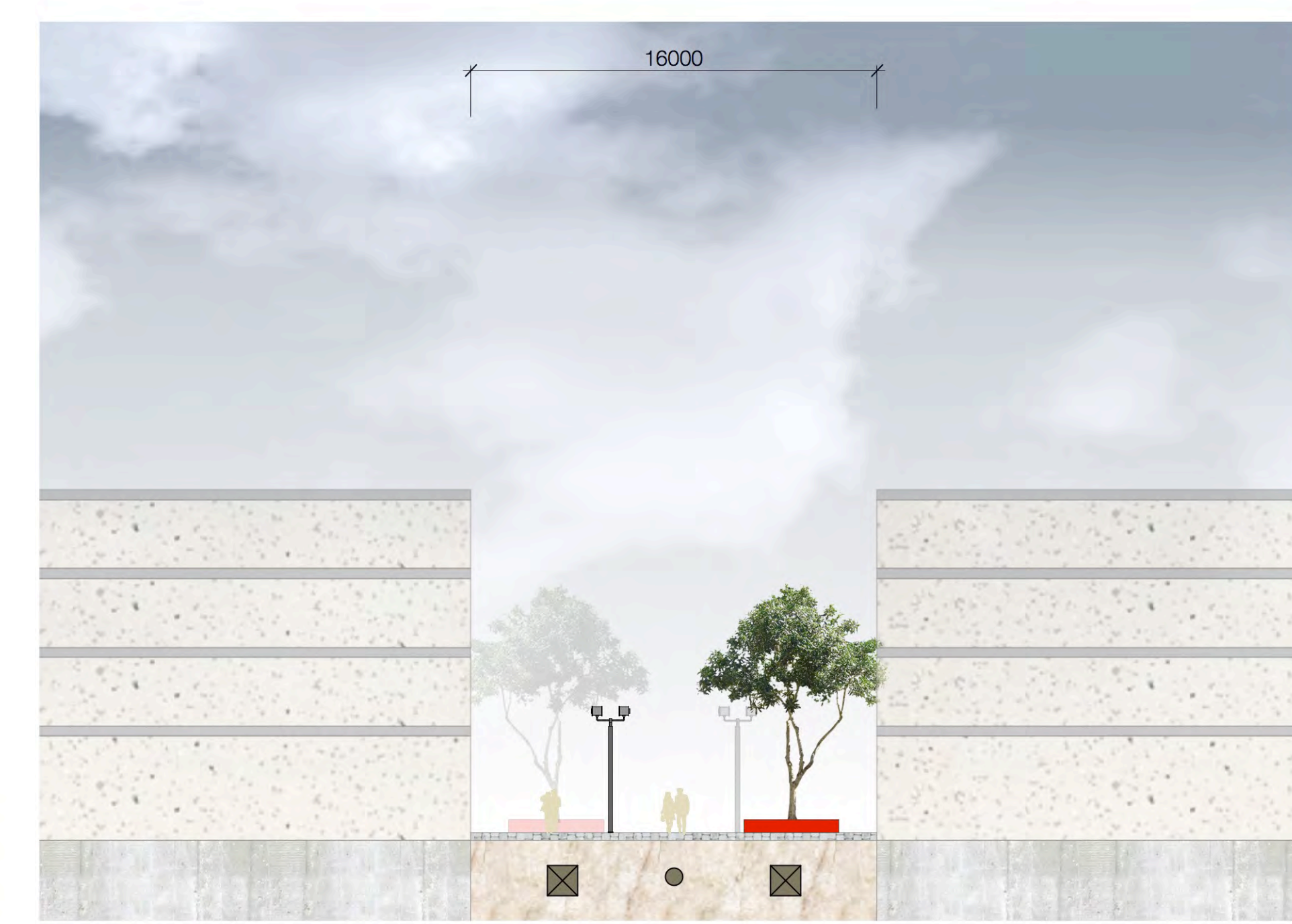

G-G Play Street

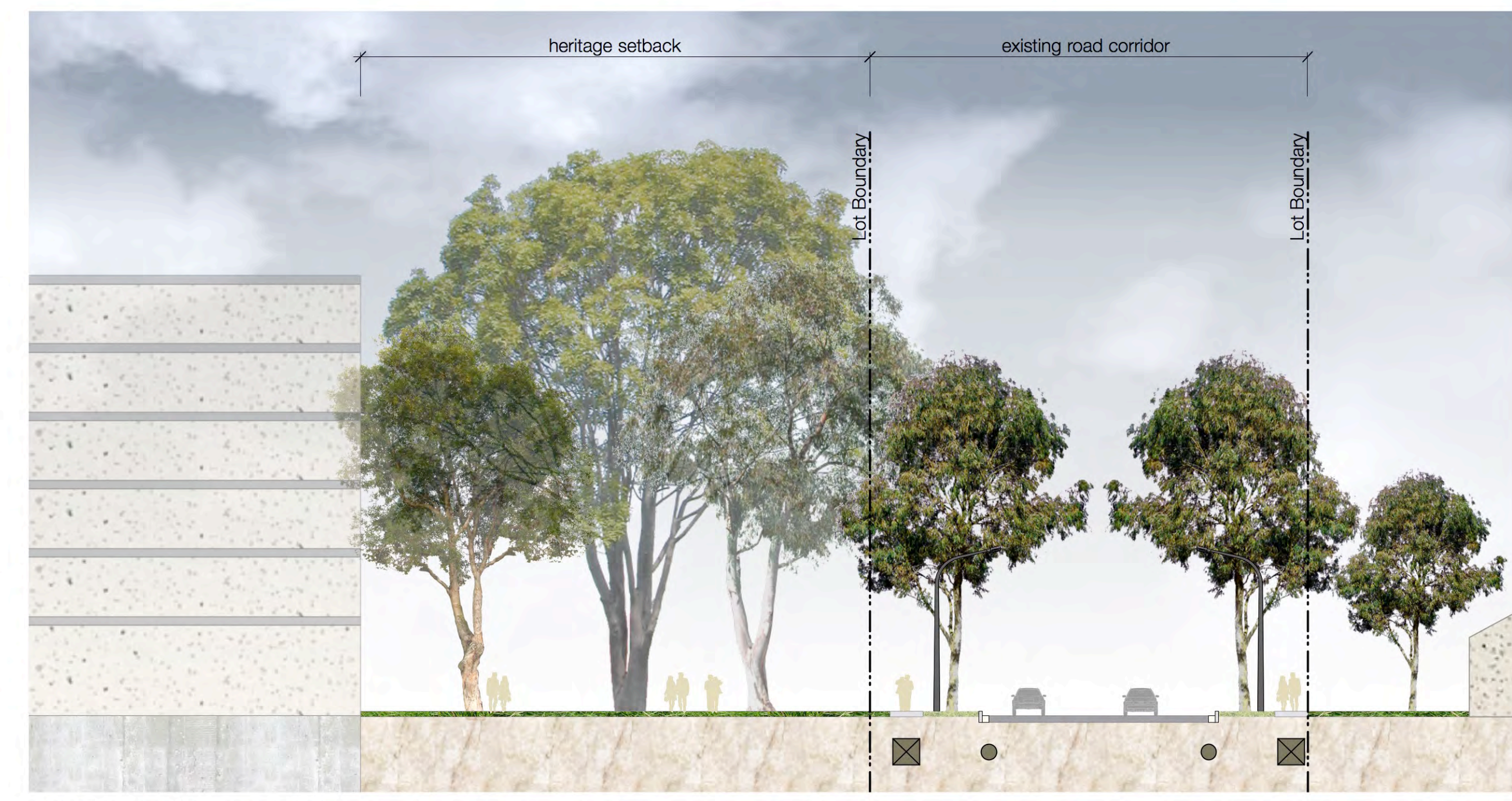
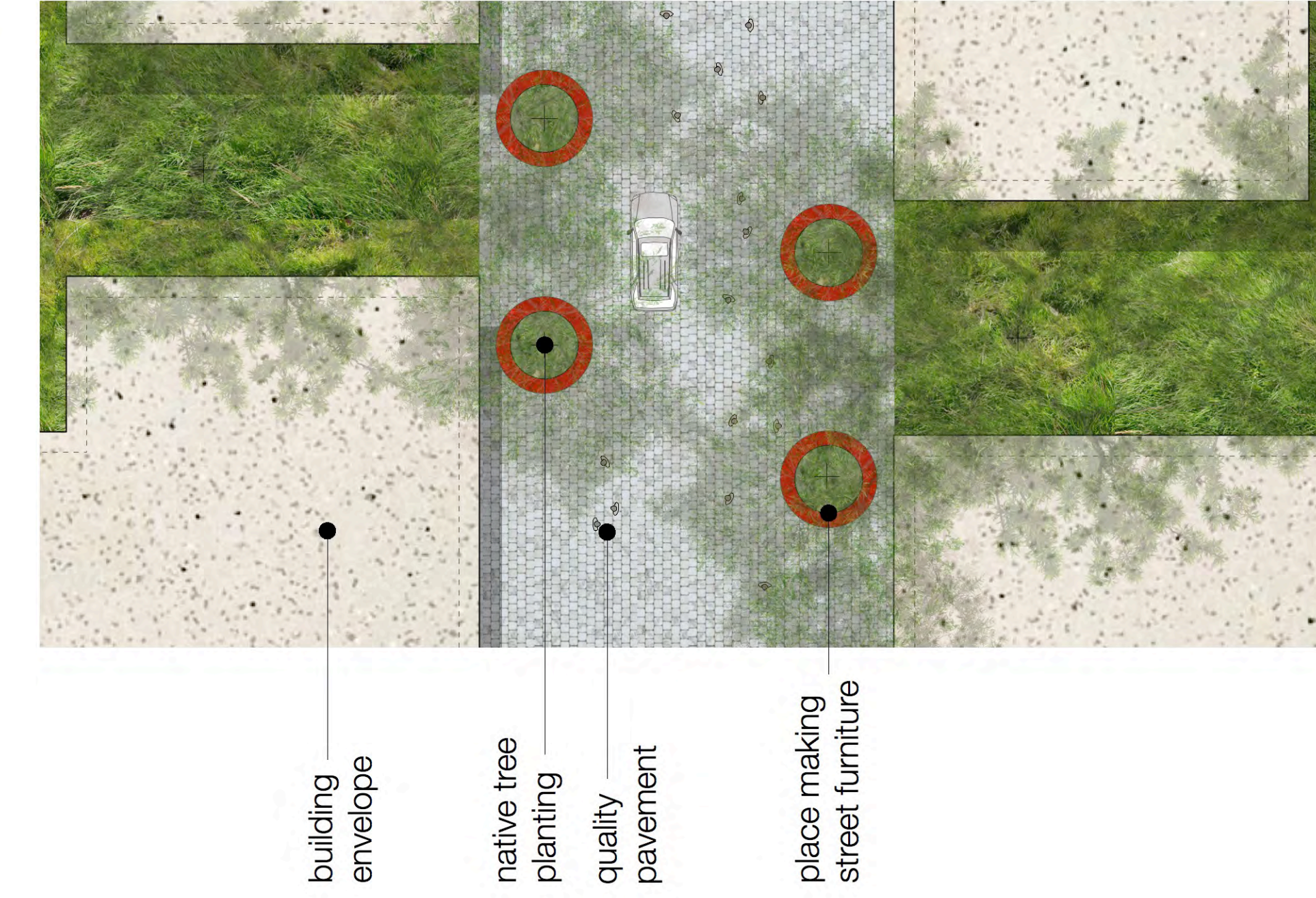

C-C Wharf Road



section  
plan

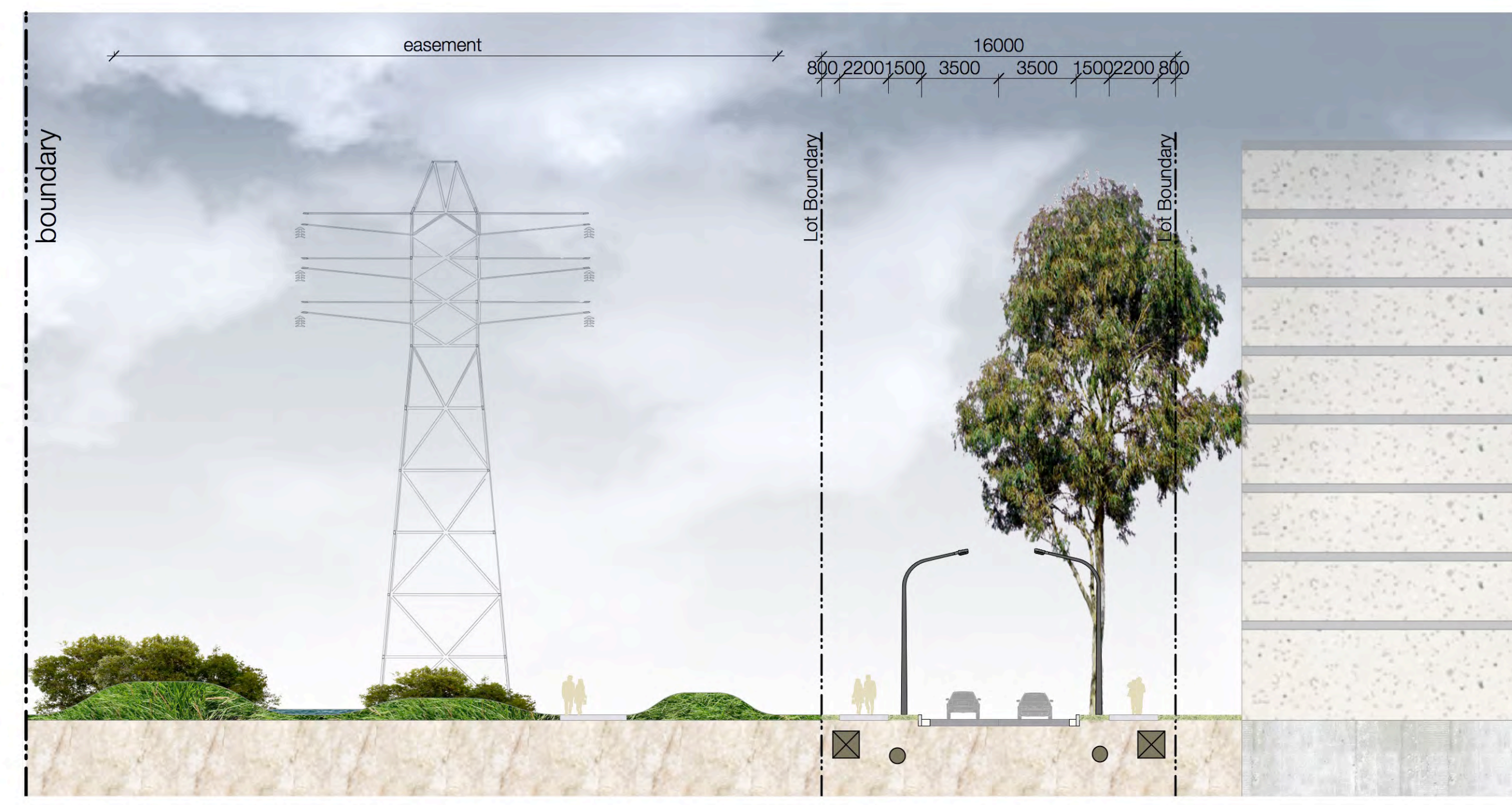

F-F Park Street

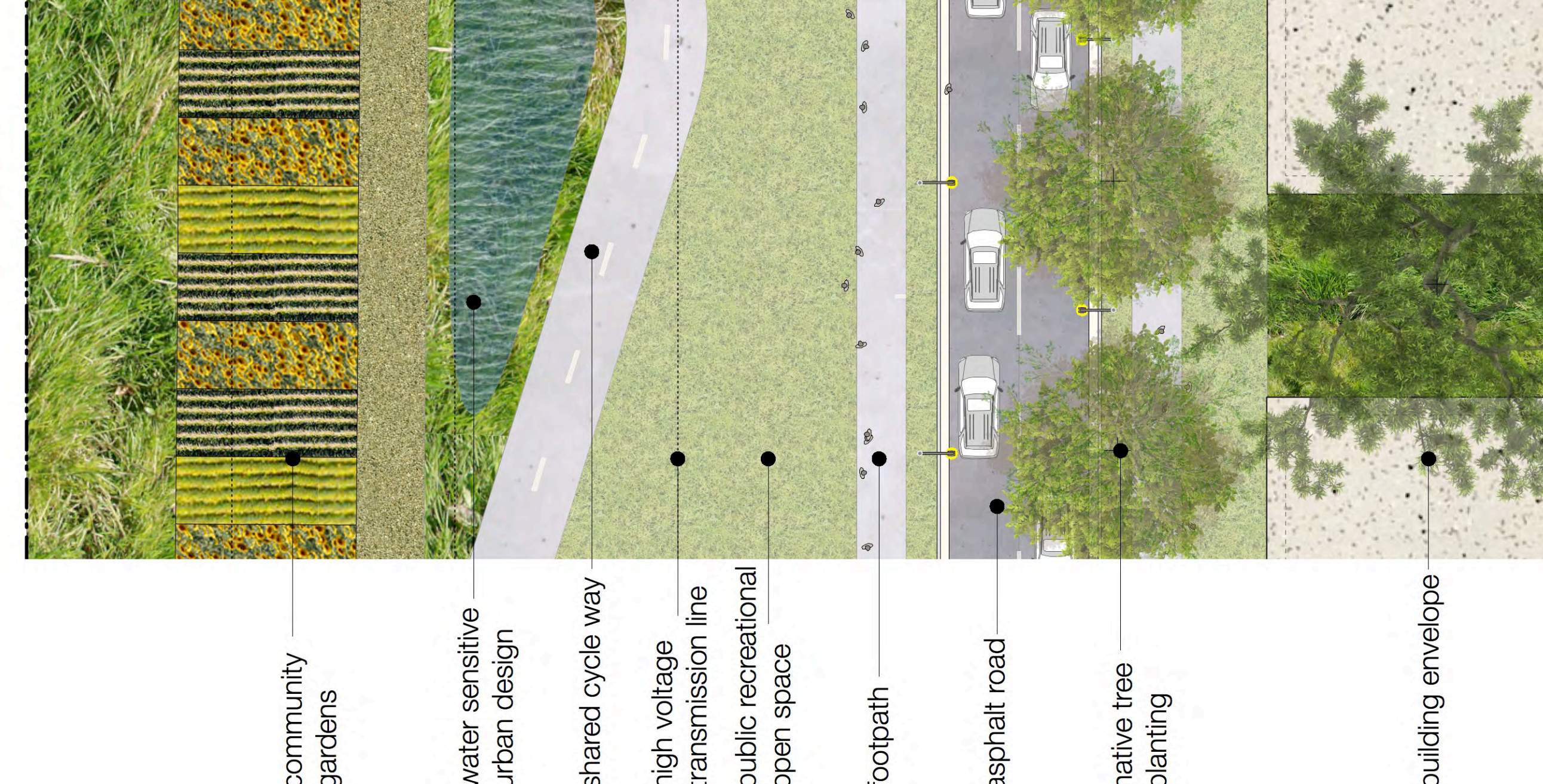

section  
plan



# Flowering Regime and Plant List

PLANT	SPRING			SUMMER			AUTUMN			WINTER		
	October	November	December	January	February	March	April	May	June	July	August	
<b>TREES</b>												
<i>Angophora costata</i> Smooth-barked Apple Height: 20m												
<i>Angophora floribunda</i> Rough-barked Apple Height: 30m												
<i>Banksia ericifolia</i> Heath-leaved Banksia Height: 5m												
<i>Corymbia gummifera</i> Red Bloodwood Height: 20-30m												
<i>Dicksonia antarctica</i> Soft Tree Fern Height: 5m												
<i>Elaeocarpus reticulatus</i> Bluemum Ash Height: 8m												
<i>Eucalyptus haemastoma</i> Scrubby gum Height: 15-20m												
<i>Eucalyptus microcorys</i> Tallowwood Height: 40m												
<i>Eucalyptus moluccana</i> Grey Box Height: 25m												
<i>Eucalyptus paniculata</i> Grey Ironbark Height: 20-30m												
<i>Eucalyptus robusta</i> Swamp Mahogany Height: 25m												
<i>Eucalyptus seligna</i> Sydney Blue Gum Height: 30-50m												
<i>Eucalyptus sideroxylon</i> "Rosea" Red Flowering Ironbark Height: 15-10m												
<i>Eucalyptus tereticornis</i> Forest Red Gum Height: 20-40m												
<i>Jacaranda mimosifolia</i> Jacaranda Height: 10-15m												
<i>Lophostemon confertus</i> Brush Box Height: 20m												
<i>Melia azedarach</i> White Cedar Height: 12m												
<i>Pittosporum undulatum</i> Sweet Pittosporum Height: 15m												
<i>Prunus serrulata</i> Japanese Cherry Height: 12m												
<i>Tristanopsis laurina</i> Water Gum Height: 6m												
<b>NATIVE SHRUBS</b>												
<i>Acacia longifolia</i> Sydney Golden Wattle Height: 4m												
<i>Acacia parramattensis</i> Parramatta Wattle Height: 15m												
<i>Baeckea brevifolia</i> Short Leaf Heath Myrtle Height: 1m												
<i>Baeckea diosmifolia</i> Fringed Baeckea Height: 1m												
<i>Breytia oblongifolia</i> Cottie Bush Height: 3m												
<i>Bursaria spinosa</i> Australian Blackthorn Height: 4m												
<i>Boronia laetifolia</i> Sydney Boronia Height: 1.5m												
<i>Callistemon citrinus</i> Crimson Bottlebrush Height: 3m												
<i>Doryanthes excelsa</i> Gymea Lily Height: 4m												
<i>Grevillea sericea</i> Pink Spider Flower Height: 2m												
<i>Grevillea sericea</i> Pink Pink Spider Flower Height: 2m												
<i>Hardenbergia violacea</i> Happy Wanderer Height: n/a climber												
<i>Kunzea ambigua</i> White Kunzea Height: 4m												
<i>Lambertia formosa</i> Mountain Devil Height: 2m												
<i>Leptospermum polygalifolium</i> Lemon Scented Tea Tree Height: 4m												
<i>Melaaleuca decora</i> White Feather Honey-myrtle Height: 4-7m												
<i>Melaaleuca nodosa</i> Prickly-leaved Paperbark Height: 4m												
<i>Melaaleuca thymifolia</i> Thyme-leaf Honey-myrtle Height: 1.5m												
<i>Notelaea longifolia</i> Mock Olive Height: 3m												
<i>Xanthorrhoea arborea</i> Grass Tree Height: 2m												
<b>NATIVE GRASSES</b>												
<i>Carex appressa</i> Tall Sedge Height: 1m												
<i>Dianella caerulea</i> Blue Flax-Lily Height: 1m												
<i>Dianella revoluta</i> Black-anther Flax-lily Height: 1m												
<i>Ficinia nodosa</i> Knobby Club Rush Height: 1m												
<i>Juncus pallidus</i> Pale rush Height: 1.5m												
<i>Juncus usitatus</i> Tassel Sedge Height: 1m												
<i>Lomandra longifolia</i> Spring-head Mat-rush Height: 0.8m												
<i>Lomandra multiflora</i> Many-flowered Mat-rush Height: 0.9m												
<i>Poa labillardieri</i> Tussock grass common Height: 1.3m												
<i>Themeda triandra</i> Kangaroo grass Height: 1.5m												
<b>SHADE TOLERANT PLANTS AND FERNS</b>												
<i>Adiantum aethiopicum</i> Maidenhair Fern Height: 0.45m												
<i>Alocasia brisbanensis</i> Curtewail Height: 1.5m												
<i>Asplenium australasicum</i> Bich Nest Fern Height: 1.2m												
<i>Alpinia caerulea</i> Native Ginger Height: 1.5m												
<i>Archontophoenix cunninghamiana</i> Bangalow palm Height: 20m												
<i>Cordylina fruticosa</i> Palm Lily Height: 4m												
<i>Cordylina petiolaris</i> Palm Lily Height: 4m												
<i>Culcita dubia</i> Soft Bracken Height: 1m												
<i>Cycas revoluta</i> Sago Palm Height: 1m												
<i>Pteridium esculentum</i> Austral bracken Height: 0.6-1.5m												

# Planting Philosophy

Benson and Howell [1990] categorise the pre-existing vegetation in the area prior to urban intervention as Cumberland Plain Woodland, Turpentine Ironbark Forest and Blue Gum High Forest: "The country around Parramatta, or Rose Hill as it was first called, was explored first by Governor Phillip in April 1788. John White, accompanying Phillip, describes the Parramatta River below the present Church Street bridge: 'The banks of it where now pleasant, the trees immensely large, and at a considerable distance from each other; and the land around us flat and rather low, but well covered with the kind of grass just mentioned [i.e. rich and succulent]. The 'immensely large trees' were probably part of the Cumberland Plain Woodland of Grey Box, *Eucalyptus moluccana*, and Forest Red Gum, *Eucalyptus tereticornis*, with an open grassy understorey that extended westward from Parramatta across the Cumberland Plain..... North-east of Rydalmere, Parramatta included areas of Turpentine Ironbark Forest with Blue Gum High Forest in more favourable situations. High Forest remnants survive at Mobbs Hill, where Blackbutt and Sydney Blue Gum trees grow with a shrubby understorey."



ABOVE. A view of part of Parramatta Port Jackson, J.W. Lewin, 1809. Courtesy State Library of New South Wales

The planting design will be using predominantly indigenous species that reflect the regions character of the Cumberland Plain Woodland, Turpentine Ironbark Forest and Blue Gum High Forest. This plant mix will be enriched by blossom trees in the public domain of the main boulevard. A mix of low water usage local trees, shrubs and grasses will be selected to create an attractive, colourful and low maintenance public domain.

"Parramatta was established at the tidal limit of the Parramatta River near the junction of the sandstone and shale. In this watercolour of about 1809, looking westward from the northern shore, sandstone outcrops are evident in the foreground and in the river, where they are being used as a ford. Cumberland Plain Woodland on the shale has been partly cleared for the town and surrounding farms."



Turpentine Forest

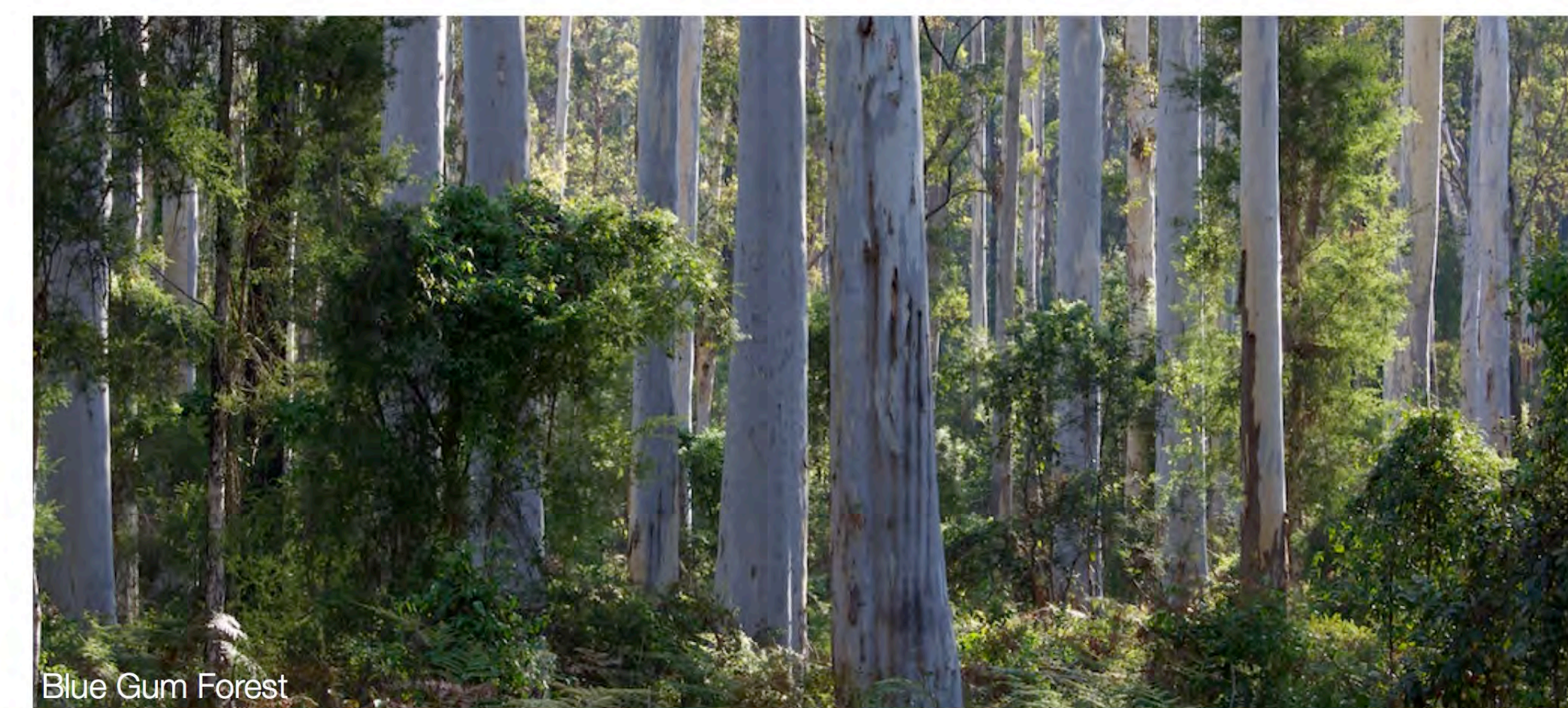

Blue Gum Forest

# Street Tree Concept



## STREET TREE PLANTING

- A.C. Angophora costata
- E.H. Eucalyptus haemastoma
- E.M. Eucalyptus microcorys
- E.P. Eucalyptus punctata
- E.R. Eucalyptus robusta
- E.S. Eucalyptus sideroxylon "Rosea"
- J.M. Jacaranda mimosifolia
- L.C. Lophostemon confertus
- P.S. Prunus serrulata
- T.L. Tristanopsis laurina